

44/40, 38/40, 25/20, 32/20 AND .218 BEE CAL. LEVER ACTION RIFLE

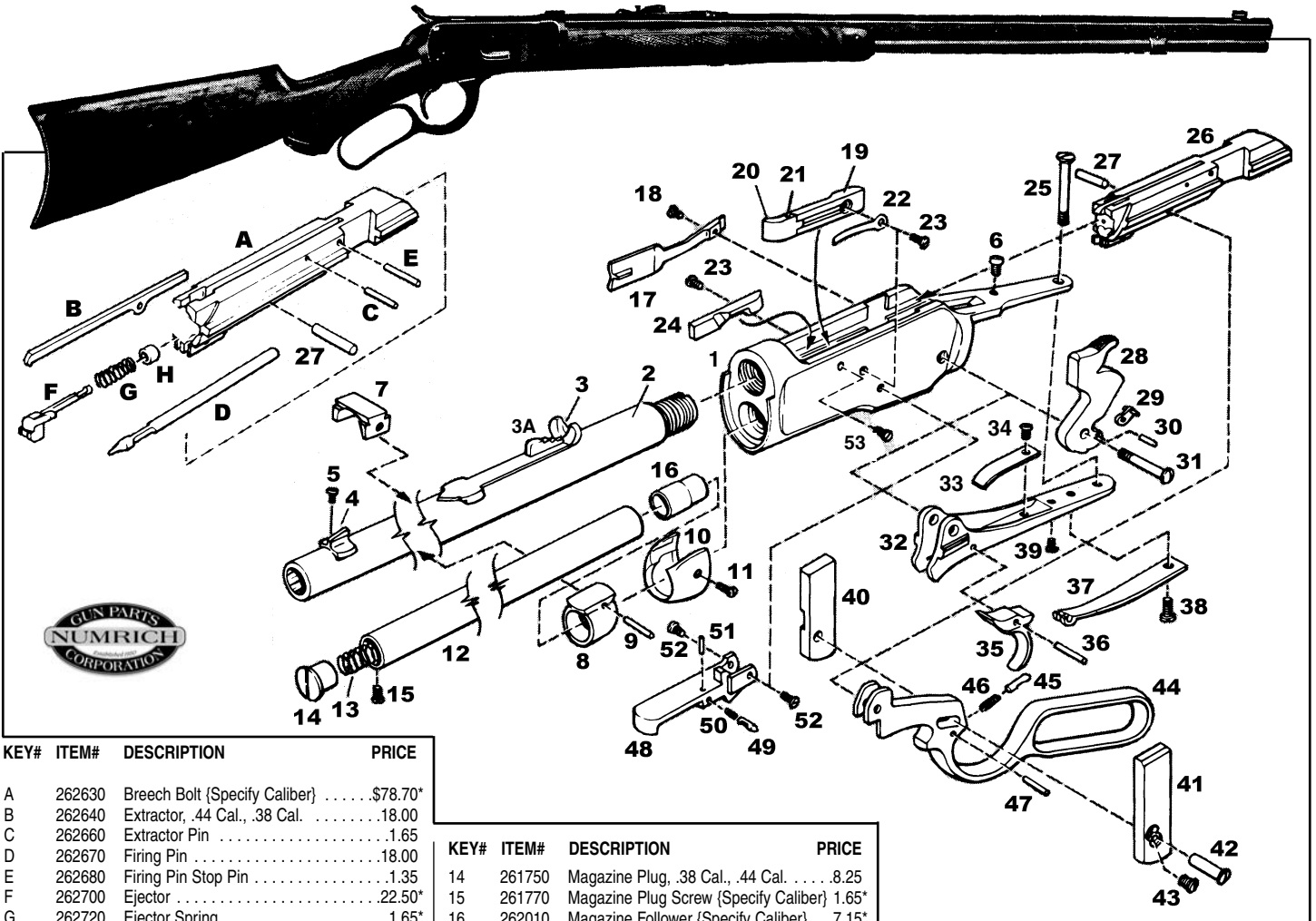

KEY#	ITEM#	DESCRIPTION	PRICE
A	262630	Breech Bolt (Specify Caliber)	\$78.70*
B	262640	Extractor, .44 Cal., .38 Cal.18.00
C	262660	Extractor Pin1.65
D	262670	Firing Pin18.00
E	262680	Firing Pin Stop Pin1.35
F	262700	Ejector22.50*
G	262720	Ejector Spring1.65*
H	228910	Ejector Collar1.65
1	314400	Receiver, .32/20, .25/20, Good Condition (FFL Req'd)75.65*
2	528520	Barrel, .44 Mag, 16"50.60
3	267860	Rear Sight Assembly17.85
3A	267790	Rear Sight Elevator2.60
4	82550	Front Sight11.30
5	260970	Front Sight Screw1.65*
6	296250	Tang Sight Screw, Front3.35
7	261050	Forend Tip Tenon8.95
8	316010	Magazine Ring (Specify Caliber)20.95*
9	261090	Magazine Ring Pin1.65*
10	316020	Forend Tip (Specify Caliber & If Round or Octagon Barrel)13.50*
11	261200	Forend Tip Screw (2 Req'd)1.65ea
12	295540	Magazine Tube, {.38 Cal., .44 Cal., 20"}11.85
12	295600	Magazine Tube, {.38 Cal., .44 Cal., 26"}17.70
	296170	Magazine Tube, .25-20, .32-20, .218 Bee, 24" - Notched For Band Screw17.70
	296200	Magazine Tube, .25-20, .32-20, .218 Bee, 23-1/2" - Plain, No Notch16.00
13	800100	Magazine Spring,4.40
14	366390	Magazine Plug, .25-20, .32-207.95*

KEY#	ITEM#	DESCRIPTION	PRICE
14	261750	Magazine Plug, .38 Cal., .44 Cal.8.25
15	261770	Magazine Plug Screw (Specify Caliber)	1.65*
16	262010	Magazine Follower (Specify Caliber)7.15*
17	531520	Spring Cover28.10
18	266760	Spring Cover Screw2.30
19	262040	Cartridge Guide, Left14.25*
20	262060	Cartridge Stop, .44-4014.55
21	262080	Cartridge Stop Joint Pin1.65
22	262090	Cartridge Stop Spring4.50*
23	262100	Cartridge Guide Screw2.30
24	262110	Cartridge Guide, Right Hand (Specify Caliber)16.85*
25	301490	Tang Screw, Upper6.60
26	262180	Breech Bolt Assembly {Specify Caliber}96.55*
27	301280	Pin {Lever And Breech Bolt}2.65*
28	262200	Hammer44.95*
29	262210	Hammer Stirrup1.65
30	262220	Hammer Stirrup Pin1.65
31	266120	Hammer Screw1.90
32	262240	Lower Tang34.25*
33	262250	Trigger Spring - 1 5/8" Measurement. Measure From Screw Hole To Trigger Opening.4.30*
33	262260	Trigger Spring - 1 3/8" Measurement. Measure From Screw Hole To Trigger Opening.4.30
34	262270	Trigger Spring Screw1.65

KEY#	ITEM#	DESCRIPTION	PRICE
35	262290	Trigger28.10
36	262320	Trigger Pin1.65
37	539540	Mainspring18.00
38	266560	Mainspring Screw1.65
39	266570	Screw {Mainspring Strain}1.65
40	262400	Locking Bolt, Right21.35*
41	262410	Locking Bolt, Left21.35*
42	262430	Locking Bolt Pin3.00
43	227460	Screw {Locking Bolt Pin}1.65
44	262490	Finger Lever56.25*
45	262510	Friction Stud1.65
46	262520	Friction Stud Spring1.65
47	262530	Friction Stud Stop Pin1.65
48	262550	Carrier, Stripped, .25-20, .32-2019.15
49	262560	Carrier Stop (Specify Caliber)3.45
50	262590	Carrier Stop Spring1.65*
51	262600	Carrier Stop Pin1.65*
52	265470	Carrier Screw (2 Req'd)1.70ea
53	265820	Screw {Lever & Breech Block Pin Hole Plug}1.65

NI = NOT ILLUSTRATED * = PART IS IN LIMITED QUANTITY. PLACE THE ITEM OR ITEMS ON ORDER, AND WE WILL SHIP THEM IF AVAILABLE.

WINCHESTER ACCESSORIES

WINCHESTER MODEL 95 CALIBERS .35, .303, .30-06, .405 WINCHESTER & .30 ARMY (.30-40 KRAG)

MFR#	ITEM#	DESCRIPTION	PRICE
-	237810	Carrier, .30 Army (.30-40 Krag) . . .	\$56.25
-	237720	Carrier, .30-06	56.25
-	237580	Carrier, .303 Cal.	56.25
-	236900	Carrier, .35 Cal.	56.25
-	237770	Carrier, .405 Win	56.25
-	237840	Carrier Cam Lever, .30 Army (.30-40 Krag)	44.95
-	237740	Carrier Cam Lever, .30-06	44.95
-	237610	Carrier Cam Lever, .303 Cal.	44.95
-	236930	Carrier Cam Lever, .35 Cal.	44.95
-	237800	Carrier Cam Lever, .405 Win	44.95
-	237820	Carrier Cradle, .30 Army (.30-40 Krag)	50.65
-	237730	Carrier Cradle, .30-06	50.65
-	237600	Carrier Cradle, .303 Cal.	50.65
-	236920	Carrier Cradle, .35 Cal.	50.65
-	237790	Carrier Cradle, .405 Win	50.65
3395	763520	Carrier Cradle & Cam Lever Pin	2.75
3895	763530	Cartridge Stop, .303, .30-40	27.00
3995	763540	Cartridge Stop, .35, .30-06, .30-30, .405 Cal.	27.00
-	237850	Ejector, .30 Army (.30-40 Krag)	36.60
-	237750	Ejector, .30-06	36.60
-	237620	Ejector, .303 Cal.	36.60
-	236940	Ejector, .35 Cal.	36.60
-	237760	Ejector, .405 Win	36.60
4795	234430	Ejector Spring	1.65
7195	234490	Finger Lever Catch Plunger	2.60
7295	234510	Finger Lever Catch Spring	1.65
7595	234540	Finger Lever Link Pin	2.60
6695	763550	Finger Lever Lock	46.00
6995	234480	Finger Lever Lock Plunger Spring	1.65
7395	234520	Finger Lever Pin	1.65
-	885090	Firing Pin	46.15
5995	234450	Firing Pin Lock	21.35
6095	234470	Firing Pin Recoil Lock	20.25
8195	234550	Forend Stud	6.20
8795	234570	Hammer Screw	2.30
9495	234580	Links	28.10
11795	763560	Rear Band Screw, Carbine	4.65
12395	763570	Sear	30.90
12495	234590	Sear Pin	1.65
12895	234610	Trigger	28.10

WINCHESTER MODEL 67 SINGLE SHOT .22 S, L, & LR

MFR#	ITEM#	DESCRIPTION	PRICE
-	82550	Front Sight	11.90
-	395060	Rear Sight W/Elevator, Replacement	5.00
867	251080	Buttplate	14.55*
967	148770	Screw (Buttplate, 2 Req'd)	2.70ea
1067	220990	Firing Pin	29.25*
1767	82740	Trigger Guard With Two Screws, Replacement	9.30
1867	231960	Guard Bow Screw (2 Req'd)	1.65ea
2167	233850	Extractor/Sear, .22 Cal.	14.55
2267A	233220	Sear Spring, New Style	4.10*
2667	233950	Trigger	8.15*
9069A	701200	Stock Stud Screw	5.10
8875	254600	Stock Stud	4.30
9269A	233890	Escutcheon	2.85

WINCHESTER MODEL 20 .410 SINGLE BARREL

ITEM#	DESCRIPTION	PRICE
299010	Buttstock Bolt, Model 20	\$8.95
299020	Barrel Trunnion, Model 20	16.85
299030	Ejector Spring, Model 20	2.35
299040	Hammer, Model 20	21.35
299050	Hammer Spring Guide Rod, Model 20	5.60*
299060	Locking Bolt, Model 20	16.35
299070	Trigger, Model 20	11.25

WINCHESTER MODEL 41 .410 GA. BOLT ACTION

PART#	ITEM#	DESCRIPTION	PRICE
441	299120	Bolt Head, Model 41	27.65
1541	299150	Firing Pin, Model 41	16.85
1841	299160	Firing Pin Head, Model 41	8.45
2541	299210	Sear, Model 41	16.85
2641	299230	Sear Spring, Model 41	2.35

WINCHESTER 90-06 REPLACEMENT .22 CAL. OCTAGON BARRELS

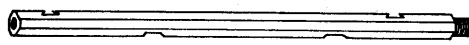

Fully finished, blued-steel, .750" A.F., 24" long. Fits models 1890, 1906 and 62A. Sights not included.

.22 S, L, LR BarrelITEM#720930 **\$73.45**
.22 Short BarrelITEM#729380 **\$73.45**

WINCHESTER RIFLE STOCK BLANK

Turned and contoured plain hardwood blank. 32" long x 1-1/2" thick with cheek-piece and pistol grip. Originally manufactured by Winchester for the model 670 bolt action rifle. ITEM#295130 **\$21.35**

SCREWS FOR WINCHESTER TANG SIGHTS

Blued-steel replacements for Lyman or Marbles tang sights requiring longer than standard length screws.

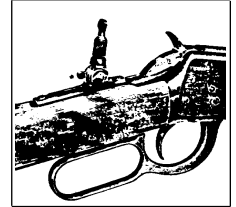

Front screw - Fits Models 1890, 1892, 1894, 1873, 53, 55 and High & Low Wall Single Shot. ITEM#296250 **\$3.35ea**

Rear screw - Will fit Models 1894, 1873, 1892, 53, 55 and High & Low Wall Single Shot. ITEM#296270 **\$3.35ea**

Rear screw - Fits Models 1890 and 1906. ITEM#296260 **\$3.35ea**

LYMAN NO. 2 RIFLE TANG SIGHT

Manufactured by Lyman to the same specifications they used a century ago on their classic original 1878 sight. Blued-finish, all-steel construction with height index marks on the aperture post. .093" quick sight hunting aperture and .040" large disk target aperture.



Includes replacement tang screw and front tang screw. Fits Winchester models 1885, 1886, 1890, 62A and 94. Will also fit Rossi M92 and M62. ITEM#296850 **\$87.10**

WINCHESTER CRESCENT STEEL BUTTPLATE



Made in the U.S.A. from investment cast 4140 steel. Measures 1 1/2" long x 7/8" wide. Fits models 92, 94, 73, 86, 95 & High/Low Wall. Supplied as cast, in the white, with sprue and attaching screws. Final fitting, polish and finish is required.

ITEM # 883930 **\$25.20**

WINCHESTER 52 / 75 RIFLE 5 ROUND .22 LR MAGAZINE



Blued-steel replacement. Fits bolt action models 52, 56, 57, 69, 69A & 75. ITEM#294390 **\$15.05**

MAGAZINE TUBES FOR WINCHESTER AND MARLIN LEVER ACTION RIFLES

Blued-steel replacements. Drilled for magazine plug screw. Choose from the following list for Winchester Models 94, 92, 53, 73, 64 and 55; Sears M-54; and Marlin Models 93, 94, 89 and 36. Fits calibers 30-30, .44, .38/55, .38/40 and .357.

12" long ITEM#295470 **\$9.40** | 23-5/8" long ITEM#295580 **\$17.70**
13-1/4" long ITEM#295530 **\$9.40** | 25-1/4" long ITEM#295600 **\$17.70**
20" long ITEM#295540 **\$11.85**

Choose from the following list for Winchester 92 and 53; and Marlin 94 and 89. Fits .25/20, .32/20 and .218 Bee calibers.

9-5/8". Notched for band screw.ITEM#296080 **\$9.40**
13-1/2". Blank tube, no cuts, in the white, steel.ITEM#296110 **\$11.85**
10-3/8". Original, blued-steel with notchITEM#296140 **\$14.80**
23-1/2". Notched for band screw, blued-steel replacement.ITEM#296170 **\$17.70**
23-1/2". Plain, no notch, blued-steel replacement.ITEM#296200 **\$16.00**

For Win. 71 & 86, Order: - 26". Blued-steel replacement.ITEM#367990 **\$21.35**

WINCHESTER ACCESSORIES

WINCHESTER 88 & 100 5 ROUND .243 / .308 MAGAZINES



Blued-steel replacements.

Model 100 Magazine. ITEM#198720-01 **\$55.15**
Model 88 Magazine. ITEM#198720-02 **\$55.15**

WINCHESTER 9422 XTR CLASSIC RIFLE BARRELS

New, factory original 22" blued-steel barrels with front

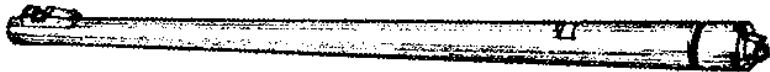

sight ramp for the .22 caliber lever action 9422 and 9422M XTR rifles (sights not included).
Model 9422 (.22 S, L, LR) ITEM#704600 **\$70.25**
Model 9422M (.22 Win Magnum) ITEM#704610 **\$75.65**

.22 LR INNER MAGAZINE TUBE FOR WINCHESTER MODEL 190

New brass replacement. Also fits standard front sight Models 150, 250, 270 and 290.
ITEM#250410 **\$16.55**



MAINSRING FOR WINCHESTER MODELS 53, 73, 76, 92 AND PRE 64 MODEL 94

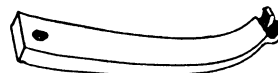

Blued-steel replacement. Can be fitted to Models 90-06 and 1886.
ITEM#539540 **\$18.00**

STOCK AND FORENDS FOR WINCHESTER

ITEM#	DESCRIPTION	PRICE
WINCHESTER MODEL 250		
231140	Forend, Plain	13.50
586470	Forend, Model 250, Checkered	16.85
590310	Forend, Model 250, Uncheckered (Lever Action Only)	13.50
WINCHESTER MODEL 1500W-1500FC		
586610	Forend, Model 1500Xtr, Checkered Walnut	28.10
WINCHESTER MODEL 255		
231140	Forend, Plain	13.50
WINCHESTER MODEL 290		
231140	Forend, Plain	13.50
586490	Forend, Model 290, Checkered	16.85

ITEM#	DESCRIPTION	PRICE
WINCHESTER MODEL 42		
586470	Action Slide Handle (Forend) - Used, Good Condition	64.40
WINCHESTER MODEL 94-22		
587590	Stock With Buttplate, Walnut - Refinished	37.05
587600	Stock With Buttplate, Walnut - Cut For Medallion On The Side, Refinished	32.10
WINCHESTER MODEL 94-22		
586580	Forend, Refinished	19.60
WINCHESTER MODEL SUPER X		
586320	Forend, Plain Walnut	37.45*
586220	Stock, Checkered Walnut - Refinished With White Line Spacer & Buttpad	59.00

WINCHESTER FACTORY RED RIFLE PAD

Smooth pad with Winchester logo. Includes black plastic spacer. Measures 4.9" long x 1.6" wide x .400" thick.



ITEM#271290 **\$5.95**

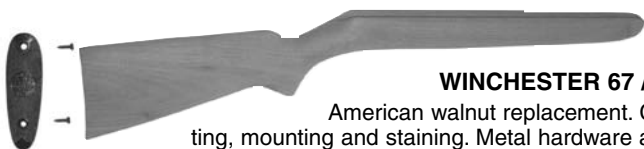

WINCHESTER 67 / 67A / 68 WALNUT STOCK

American walnut replacement. Completely inletted for final fitting, mounting and staining. Metal hardware and buttplate are not included.

Stock ITEM#807840 **\$89.20**
Buttplate w/Winchester Logo ITEM#251080 **\$14.55**
Buttplate Screw (2 Req'd) ITEM#148770 **\$2.70ea**

WINCHESTER SUPER X MODEL 1 12 GA. SYNTHETIC BUTTSTOCK

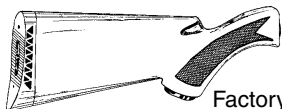

Factory new black checkered buttstock includes grip cap and black vented logo recoil pad.

ITEM#730860 **\$37.80**

WINCHESTER 100 CUT-OFF RIFLE BARRELS



Factory original, blued-steel, excellent condition. Cut just ahead of the chamber leaving no threads. Includes front sight ramp, rear sight dovetail cut and gas block. measures approximately 20 1/2" long x .970" O.D. at the cut-off end.

.308 Winchester Barrel
..... ITEM#595480-01 **\$16.05**
.284 Winchester Barrel
..... ITEM#146280 **\$14.05**

WINCHESTER TAKEDOWN MAGAZINE TUBE PARTS FOR MODELS 92 AND 94

Factory original blue steel parts.
Magazine lever screw (small caliber only)
ITEM#319610 **\$1.95**
Magazine lever plunger ITEM#319640 **\$1.70**
Magazine lever plunger spring
ITEM#319670 **\$1.25**

WINCHESTER 95 LEVER ACTION RIFLE FIRING PIN



Blued-steel replacement.
ITEM # 885090 **\$46.15**

WINCHESTER BUTTPLATE WITH LOGO

Black hard-rubber. .640" wide x 5.175" long. 3.425" between screw holes. Final fitting may be required. Original Winchester manufacture.



ITEM#235880 **\$13.95**

ORIGINAL WINCHESTER VENTED RECOIL PAD

Smooth-finished with Winchester logo. 4.7" long x 1.7" wide x .85" thick.

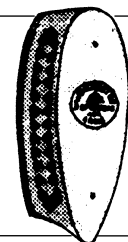

ITEM#271320 **\$6.20**

FOREND BANDS AND QD SWIVELS

New band with quick-detach base and band screw to fit Mossberg 472 & 479 rifles. Can be fitted to Winchester models 92 & 94 and Marlin 94, 89 & 336 Carbine Series. Blued-steel.

ITEM#560420 **\$8.35**

Band with Buttstock Swivel Screw Stud.
Blued-Steel. ITEM#560430 **\$11.50**

Uncle Mike's 1 1/4" Quick-Detach Swivel for Use with Base. Blued-Steel.
ITEM#538020 **\$10.90/pr**

Uncle Mike's 1" Quick-Detach Swivel for Use with Stud. Blued-Steel.
ITEM#538010 **\$ 10.90/pr**

WINCHESTER ACCESSORIES

SEARS BRAND (WINCHESTER) STOCKS AND FORENDS

Below is a list of Winchester factory stocks and forends, originally equipped on firearms sold under the Sears, Roebuck & Co. and Ted Williams store brand names. Most are new, however, some may include slight shop or storage wear. Available for both rifles and shotguns in various styles.

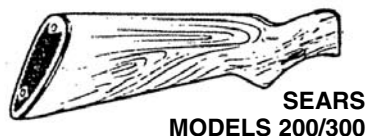

SEARS
MODELS 200/300

FRONT OF STOCK WHERE
IT JOINS RECEIVER.

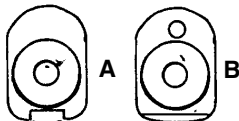

SHOTGUN STOCKS

- Sears 200 / 300 - 12 & 20 Gauge - Plain Walnut Stained Hardwood w/Recoil Pad - Style AITEM#590010 **\$39.35**
- Sears 200 / 300 - 12 & 20 Gauge - Plain Walnut Stained Hardwood w/Recoil Pad - Style BITEM#590000 **\$33.75**
- Sears 200 / 300 - 12 & 20 Gauge - Checkered Walnut w/Recoil Pad - Style BITEM#801090 **\$39.35**
- Sears 200 / 300 - 12 & 20 Gauge - Plain Walnut Stained Hardwood w/Buttplate - Style BITEM#590050 **\$33.75**

SHOTGUN FORENDS

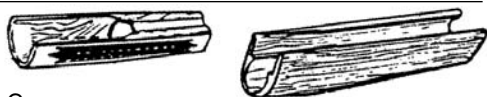

- Sears 200 - 12 & 20 Gauge - Plain Walnut Stained Hardwood - 8 1/2" OAL - (Fits Winchester 1200 & 1300 XTR)ITEM#590330 **\$18.60**
- Sears 200 - 12 & 20 gauge - Plain Walnut Stained Hardwood - 10" OAL - (Fits Winchester 1200 & 1300 XTR)ITEM#842700 **\$18.60**
- Sears 200 - 12 & 20 Gauge - Checkered Walnut - (Fits Winchester 1200 & 1300 XTR) . .ITEM#590340 **\$28.10**
- Sears 300 - 12 Gauge - Plain Walnut Stained Hardwood - (Fits Winchester 1400)ITEM#590370 **\$18.60**
- Sears 300 - 20 Gauge - Plain Walnut Stained Hardwood (Fits Winchester 1400)ITEM#590380 **\$18.60**

- Winchester 1500 XTR - 20 Gauge - Checkered WalnutITEM#842710 **\$17.70**



SEARS 3T / 4T /
5T, 53 / 53A / 73
ALSO WINCHESTER 70A, 770 & 670

RIFLE STOCKS

- Sears 5T - .22 Caliber - Plain Walnut Stained Hardwood w/Buttplate . . .ITEM#590240 **\$14.55**
- Sears 3T / 4T - .22 Caliber - Plain Walnut Stained Hardware w/Buttplate . . .ITEM#590250 **\$14.55**
- Sears 3T / 4T - .22 Caliber - Checkered Walnut w/Grip Cap & Buttplate . . .ITEM#590260 **\$22.50**
- Sears 53A / 73 - Long Action - Blind Box - Plain Walnut Stained Hardwood - Monte Carlo w/Buttplate (Fits Winchester 70A, 770 and 670)ITEM#590270 **\$50.60**
- Sears 53 - Long Action - Hinged Floorplate - Checkered Walnut Stained Hardwood - Monte Carlo w/Buttplate - (Will Not Fit Winchester 70)ITEM#590290 **\$56.25**

RIFLE FORENDS



- Sears 5T - .22 Caliber - Plain Walnut Stained Hardwood (Fits Winchester 270 & 275)ITEM#590300 **\$13.50**
- Sears 3T / 4T - .22 Caliber - Plain Walnut Stained Hardwood (Fits Winchester 150, 190, 250, 255 & 290)ITEM#590310 **\$13.50**
- Sears 54 - Walnut - 6 3/4" Long (Fits Winchester 94)ITEM#590320 **\$28.10**

SEMI-FINISHED BUTTSTOCKS & FORENDS FOR EARLY WINCHESTER LEVER ACTIONS

Straight-grained American black walnut buttstock and forend replacements closely match the original Winchester wood, providing your vintage lever action with an authentic look and feel. Fully-contoured in all areas to within approximately 1/16" of finish size, then machine sanded to remove all production marks. Final fit, finish and stain required (hardware not included).



BUTTSTOCKS (INLETTED TO ACCEPT ORIGINAL FACTORY BUTTPLATES)

- 1873 Rifle - Straight Grip - Crescent ButtplateITEM#764010 \$68.25
- 1873 Carbine - Straight Grip - Carbine ButtplateITEM#764020 \$68.25
- 1876 Rifle - Straight Grip - Crescent ButtplateITEM#764030 \$68.25
- 1885 Low Wall Rifle - Straight Grip - Crescent ButtplateITEM#764040 \$68.25
- 1885 High Wall Rifle - Straight Grip - Crescent ButtplateITEM#764050 \$68.25
- 1886 Rifle (serial # below 94,000) - Straight Grip - Crescent ButtplateITEM#764060 \$68.25
- 1886 Rifle (serial # above 94,000) - Straight Grip - Crescent ButtplateITEM#764070 \$68.25
- 1887 Shotgun - Pistol Grip - Shotgun Style ButtplateITEM#764080 \$78.75
- 1892/1894 Rifles - Straight Grip - Crescent ButtplateITEM#764090 \$68.25
- 1892/1894 Carbine - Straight Grip - Carbine ButtplateITEM#764100 \$68.25
- 1895 Rifle - Straight Grip - Crescent ButtplateITEM#764110 \$68.25
- 71 Rifle (3 7/8" upper tang) - Pistol Grip - Shotgun Style ButtplateITEM#764120 \$78.75
- 71 Rifle (2 7/8" upper tang) - Pistol Grip - Shotgun Style ButtplateITEM#764130 \$78.75

FORENDS

- 1866/1873 Rifles - Octagon - Large CaliberITEM#764140 \$47.25
- 1873 Rifle - Octagon - Small CaliberITEM#764150 \$47.25
- 1866/1873 Rifles - Round - Large CaliberITEM#764160 \$47.25
- 1873 Rifle - Round - Small CaliberITEM#764170 \$47.25
- 1866/1873 Carbine - Round - Large CaliberITEM#764180 \$47.25
- 1873 Carbine - Round - Small CaliberITEM#764190 \$47.25
- 1876 Rifle - Octagon - All CalibersITEM#764200 \$47.25
- 1876 Rifle - Round - All CalibersITEM#764210 \$47.25

- 1885 Low Wall Rifle - #1 Octagon - All CalibersITEM#764220 \$47.25
- 1885 Low Wall Rifle - #2 Octagon - All CalibersITEM#764230 \$47.25
- 1885 High Wall Rifle - #3 Octagon - All CalibersITEM#764240 \$47.25
- 1885 High Wall Rifle - #4 Octagon - All CalibersITEM#764250 \$47.25
- 1886 Rifle - Octagon - All CalibersITEM#764260 \$47.25
- 1886 Rifle (serial # below 94,000) - Round - All CalibersITEM#764270 \$47.25
- 1886 Rifle (serial # above 94,000) - Round - All CalibersITEM#764280 \$47.25
- 1886 Carbine - Round - All CalibersITEM#764290 \$47.25
- 1892/1894 Rifles - Octagon - Large CaliberITEM#764300 \$47.25
- 1892 Rifle - Octagon - Small CaliberITEM#764310 \$47.25
- 1892/1894 Rifles - Round - Large CaliberITEM#764320 \$47.25
- 1892 Rifle - Round - Small CaliberITEM#764330 \$47.25
- 1892/1894 Carbine - Round - Large CaliberITEM#764340 \$47.25
- 1892 Carbine - Round - Small CaliberITEM#764350 \$47.25
- 1894 Commemorative Post 64 - Octagon - All CalibersITEM#764360 \$47.25
- 1894 Carbine Post 64 - Round - All CalibersITEM#764370 \$47.25
- 1895 Rifle - Round - Small CaliberITEM#764380 \$47.25
- 1895 Rifle - Round - Large CaliberITEM#764390 \$47.25
- 1895 Carbine - w/o Grooves - Round - All CalibersITEM#764400 \$47.25
- 1895 Carbine - w/Grooves - Round - All CalibersITEM#764410 \$47.25
- 1895 Musket - Round - All CalibersITEM#764420 \$47.25
- 71 Rifle - Round - All CalibersITEM#764430 \$47.25
- 1894 Cowboy Conversion Post 64 - Round - Long Style - All CalibersITEM#764440 \$47.25
- Ebony Inlay - Fits 1885 and 1895 Schnabel Tip ForendsITEM#764450 \$5.25

WINCHESTER ACCESSORIES

WINCHESTER PROOF MARK HAND STAMP



Hardened steel stamp for use on wood, metal or leather surfaces. Features the letters P and W in an oval. Commonly found on the breech end of most Winchester firearm barrels including models 12 and 97 trench and riot guns. Use for restoration purposes only. Manufactured by Numrich Gun Parts Corporation.

ITEM # 850750 **\$68.20**

WINCHESTER CHECKERED STEEL SHOTGUN STYLE BUTTPLATE



Made in the U.S.A. from investment cast 4140 steel. Supplied as cast, in the white, with sprue and attaching screws. Fits models 97, 64, 70 Pre-64, 71, 86, 95, 1887 & 1901. Final fitting and finish is required.

ITEM # 247970 **\$25.20**

WINCHESTER 94-22 CLASSIC WALNUT PISTOL GRIP STOCK & FOREND



This new, factory original wood fits the Winchester 94-22 Classic lever action rifle. The plain pistol grip stock includes a black plastic sporter grip cap and a high-polish, crescent steel buttplate. The matching Saddle Ring forend measures 9 1/4" long. Purchase the stock and forend separately or in a set.

Stock
ITEM # 886100 **\$41.95**

Forend
ITEM # 886110 **\$20.95**

Stock & Forend Set
ITEM # 886120 **\$52.45**

ALUMINUM FOREND PIVOT PLATE FOR SAVAGE / WINCHESTER FIREARMS



Durable replacement pivot plate with black anodized finish. Attaching screws not included. May require minor final fitting. Fits Winchester models 37A, 340 and 840 and Savage models 24, 94, 219, 220, 240, 242, 940, 947 and 9478.

ITEM # 852270 **\$13.60**

WINCHESTER 88 WALNUT STOCK



Features a low luster lacquer finish and buttplate. Fits models with a rounded, non-scalloped recoil block.

ITEM # 932130 **\$91.90**

WINCHESTER 67 / 68 / 69 WEAVER ALL-STEEL ONE-PIECE MOUNT BASE



Blued-steel base with screws in the original box. Also fits models 57 and 60.

ITEM # 953710 **\$6.25**

WINCHESTER 64 / 64A RIFLE WALNUT PISTOL GRIP STOCK



This new, factory original stock fits Pre-64 and Post-64 Winchester lever action rifle models 64 and 64A. The plain walnut stock includes a pistol grip, a pre-drilled hole for a Q.D. swivel stud and a black plastic Winchester logo buttplate. Quantities are limited!

ITEM # 886320 **\$52.45**

WINCHESTER 1892 / 1894 FOREND TIPS

Blued-steel replacements. Choose from round or octagon in the following calibers: .30-30, .38-40, .38-55 and .44-40.



Round Barrel Forend Tip
ITEM # 882920 **\$20.95**

Octagon Barrel Forend Tip
ITEM # 882930 **\$20.95**

WINCHESTER 1 1/4" STOCK SWIVEL SET

Blued-steel replacement. Fits models 52C, 69A, 75 and 12/97 trench guns after serial #912,000 and serial #915,000 respectively.



ITEM#931850 **\$15.70**

WINCHESTER 88 / 100 WEAVER ALL-STEEL ONE-PIECE MOUNT BASE



Blued-steel base with screws in the original box.

ITEM #953720 **\$6.25**

WINCHESTER 1892 REPLACEMENT EJECTOR

Machined and hardened from carbon steel. Requires final fitting to large and small caliber bolts.

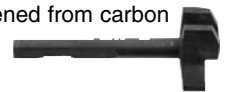

ITEM#953450 **\$31.45**

BODY - MATTE BLUE - ALL CALIBERS EXCEPT .338 WIN MAG

The BOSS (Ballistic Optimizing Shooting System) is an accuracy enhancing, anti-vibration and recoil reducing system that includes an adjustable muzzlebrake/weight. Choose from the following factory new steel parts.



Body - Matte Blue - All Calibers Except .338 Win Mag

ITEM#930020 **\$31.45**